

## FLOOR TRACKS

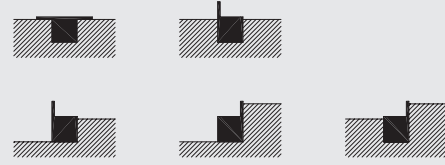

## CONFIGURATION VARIANTS

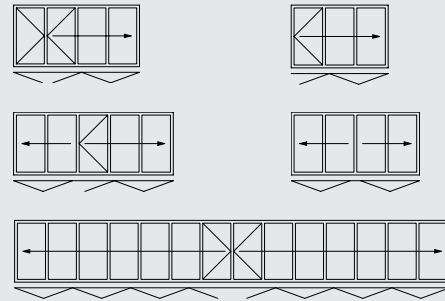

## VERTICAL SECTION

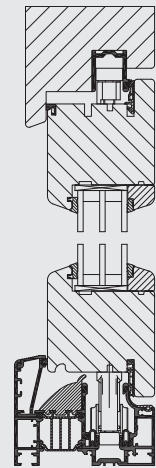

## PANEL SIZE CHART

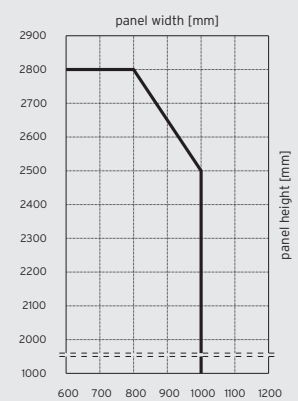

— valid for panels with fillings and glasses with a weight of max. 40 kg/m<sup>2</sup>

## VARIANTS

- ▮ Floor mounted folding glass door
- ▮ Can be folded outward, inward, to the left or to the right - as required

## PROFILE SYSTEM

- ▮ Laminated timber profiles
- ▮ 78 mm panel thickness
- ▮ Panel frame with solid mortice and tenon joints
- ▮ Standard timber: Pine and spruce, other type of timber optional
- ▮ Flush floor track without upstand for unimpeded access available
- ▮ Double wraparound seal with an additional seal in the panel joint ensure high impermeability to rain and wind
- ▮ Manufactured from a renewable source of timber

## FITTINGS

- ▮ No protruding runner and guide tracks
- ▮ Concealed fittings for one handed operation
- ▮ Lockable in any partly open position

## GLAZING

- ▮ Triple heat-insulating glass as standard
- ▮ Glass thickness up to 40 mm
- ▮  $U_g = 0,7 \text{ W/m}^2\text{K}$  with 3 x 4 mm float glass and warm edge spacer

## FINISH

- ▮ Primed according to SL colour chart as standard
- ▮ Finish according to SL colour chart optional
- ▮ Water-based lacquer

## U-VALUE

- ▮  $U_w \geq 1,00 \text{ W/m}^2\text{K}$

## MAXIMUM PANEL SIZES

- ▮ 1000 x 2500 mm
- ▮ 800 x 2800 mm
- ▮ Panel weight up to 100 kg
- ▮ Special sizes on request

## TESTED FOR

- ▮ Burglar resistance WK2 to DIN EN 1627:2011



567021064-9001 | 03.2016 | Subject to technical changes



FOLDING GLASS DOOR  
SL 78



www.solarlux.com

 **SOLARLUX**<sup>®</sup>  
glass in motion

 **SOLARLUX**<sup>®</sup>





#### ENGINEERED

Long-lasting stainless steel runners and tracks ensure easy, quiet and smooth operation of the folding glass doors.



#### BURGLARY RESISTANCE

The high quality of our Bi-Folding Doors offer tested security against burglary. Optionally there is an additional WK2 security and safety package available.



#### COMFORT

The integrated multi-point locking system and the comfortable stainless steel lever handle with catch bolt, lock and profile cylinder ensure high security.



#### HEAT INSULATION

Laminated timber and triple heat-insulating glass offer the maximum heat insulation in accordance with the best energy conservation regulations (EnEV).



#### SUSTAINABILITY

Solarlux uses FSC and PEFC certified timber from sustainable forestry. In addition all components are tested against environmental standards and are easy to separate and recycle.



#### IMPERMEABILITY

Double wraparound seal with an additional seal in the panel joint ensure highest impermeability to rain and wind.



#### WIDTH ADJUSTMENT

The overall width of the panels can be easily adjusted by adapting the hinges with a screwdriver.

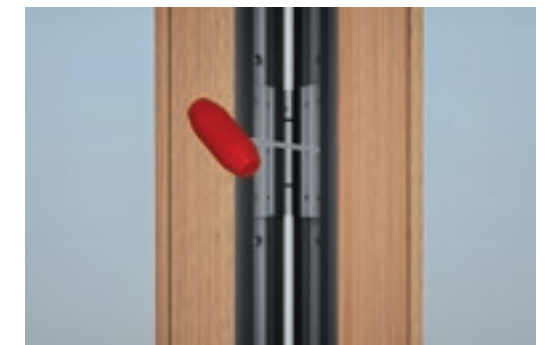

#### STABILITY

The 78mm laminated timber profiles and espagnolettes, with 24mm throw bolts, lock the panels into both the top and bottom tracks of the frame, maintaining the integrity of the system as well as providing high security.

