

MEGALINE

Bi-folding door

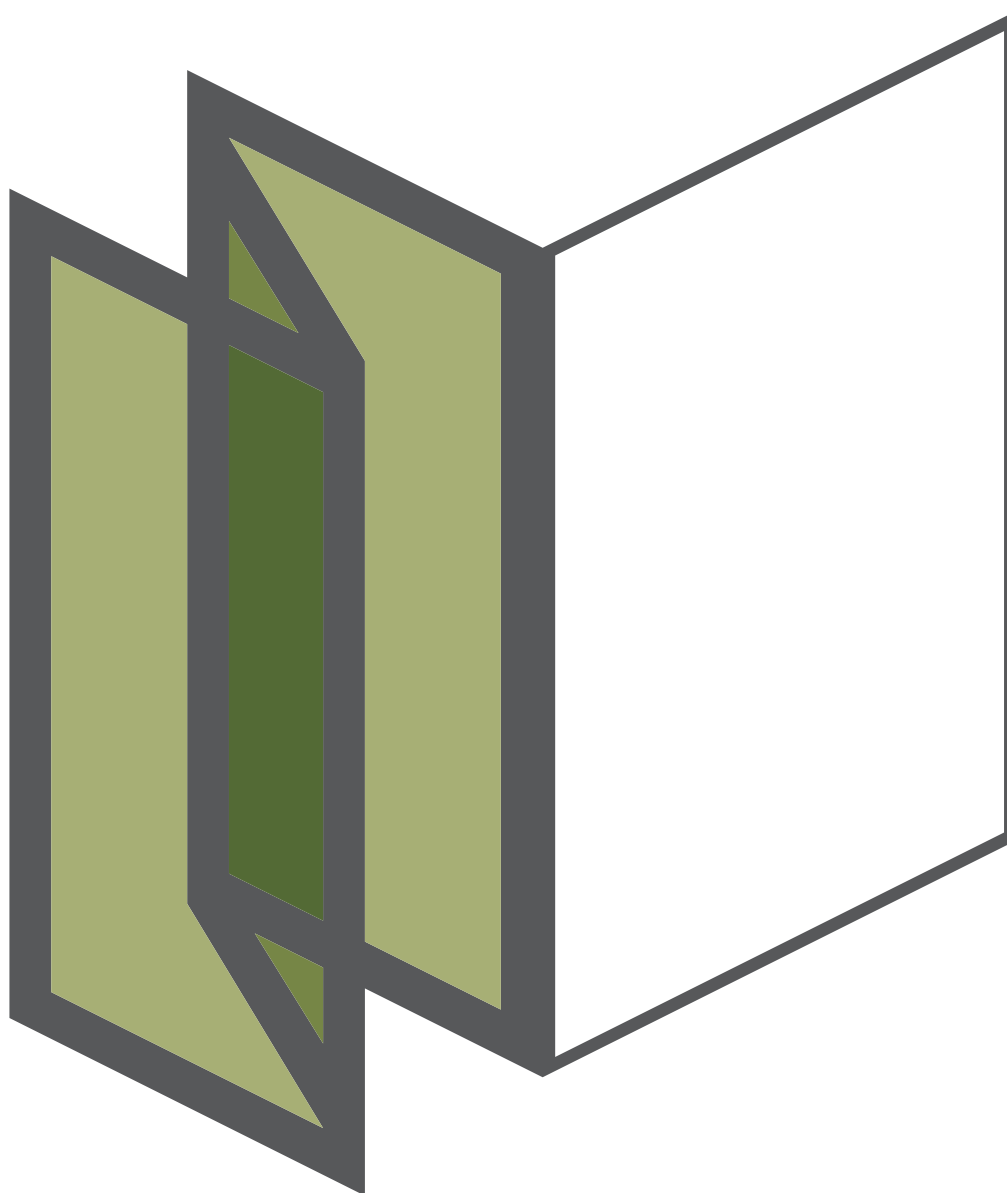

PRODUCT DATA SHEET

MEGALINE BI-FOLDING DOOR

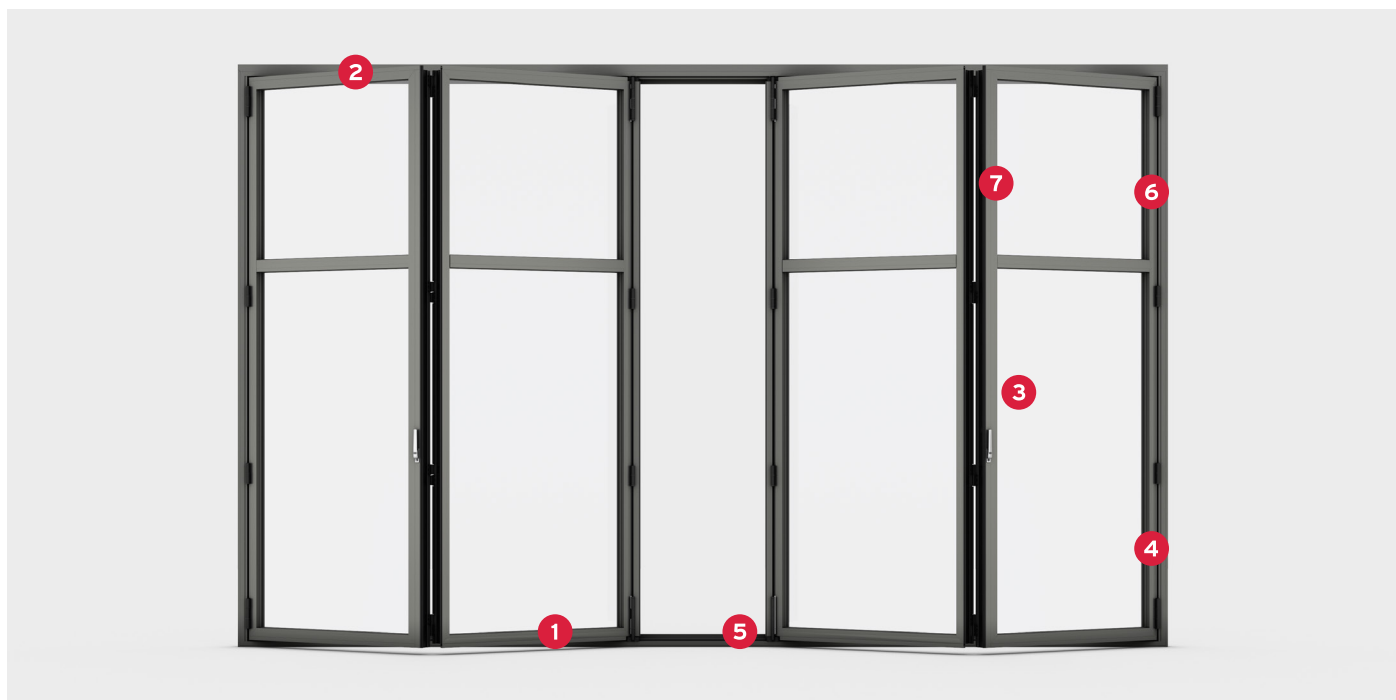

1

CARRIAGE

- Stainless steel carriage with supporting yoke and double-row grooved ball bearings
- Runs smoothly and quietly
- Optimum load transfer
- Extremely low-maintenance and non-wearing

2

LOCKING MECHANISM

- 24 mm upward and downward latch bolt in the frame
- Connection to the security technology possible
- Concealed cable routing

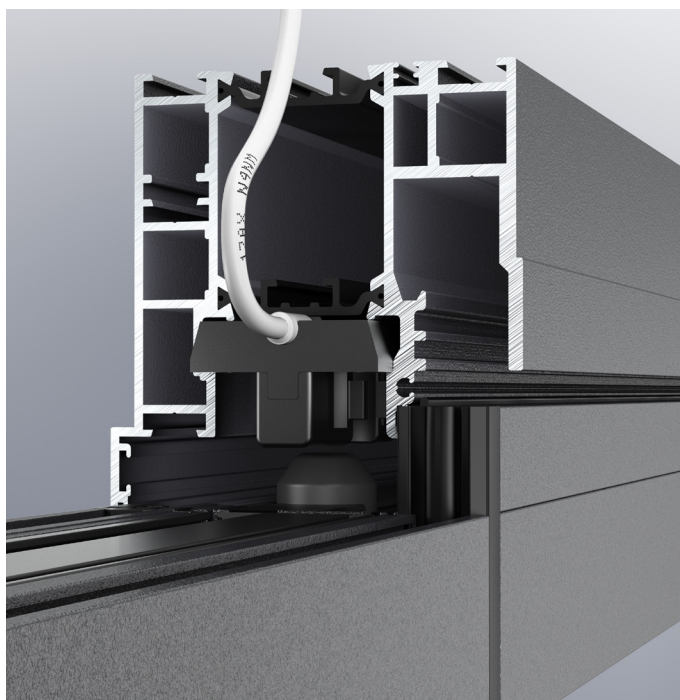



3

PANEL JOINT WITH DOUBLED PROFILES

- Attached to vertical panel profiles
- Sight line of 132.5 mm
- Further structural profiles can be added depending on structural requirements (e.g. extreme wind loads)



5

IMPACT PROTECTION 3S-PROTECTION

- High-quality, clip-in, aluminium impact protection
- Optimum locking groove coverage
- Also protects against soiling

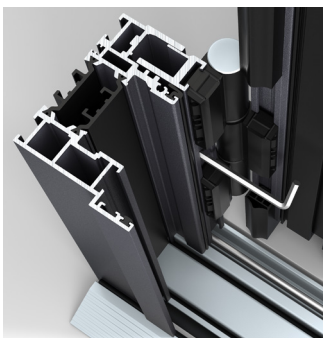

4

ADJUSTABLE PROFILE

- Easy compensation for panel tolerances
- Adjust the panels using just one profile
- No interruption to the sealing level



6

FRAME COVER

- Aesthetically pleasing, flush-mounted cover for the sub-frame screw heads
- Concealed cable routing possible between profile base and cover



7

"TWINX" CONCEALED PANEL CENTRING MECHANISM

- Uniform panel design with consistent joint alignment
- No interruption to sealing level
- Constant pressure on seal

MEGALINE BI-FOLDING DOOR

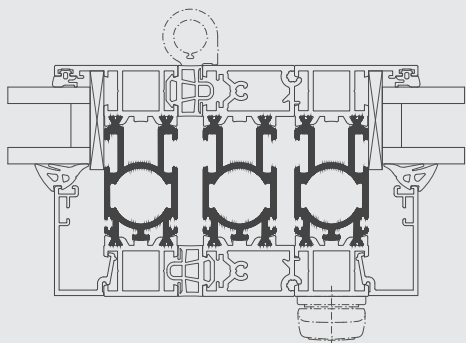

The heart of the bi-folding door

The Megaline bi-folding door has a building depth of 84 mm and a sight line of 132.5 mm. This provides sturdy profiles thanks to the bionicturtle®: a multifunctional insulating bar that combines a number of



technical details. Its shape is the basis for the stability of the slim profiles, in addition it houses the locking mechanism and fittings and guarantees perfect insulation.

Sample configurations

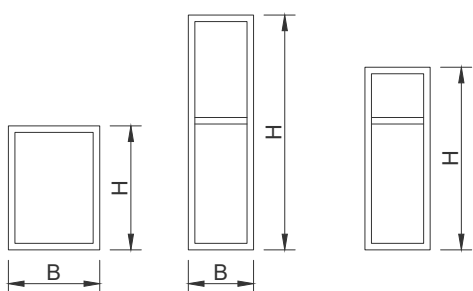

Width:
Max. 1,500 mm

Width:
Max. 900 mm

Height:
Max. 2,300 mm

Height:
Max. 4,500 mm

Horizontal rails
may be necessary
for structural
reasons for con-
struction heights
over 2,550 mm.

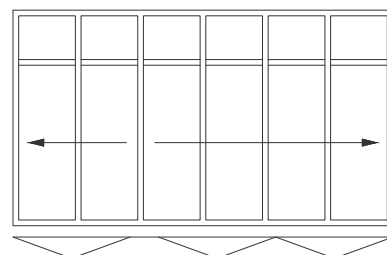
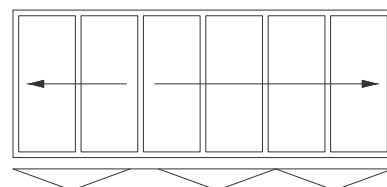
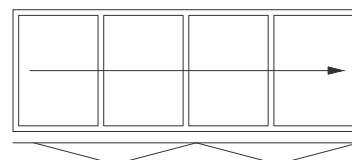
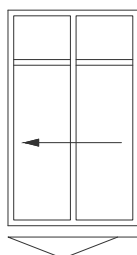
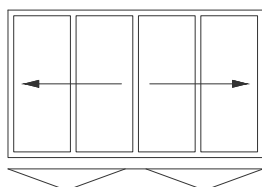
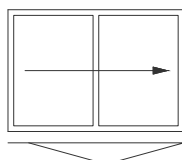

Floor track variants

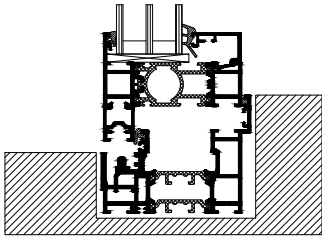

TYPE 01

- Floor track suitable for living spaces
- With rebate

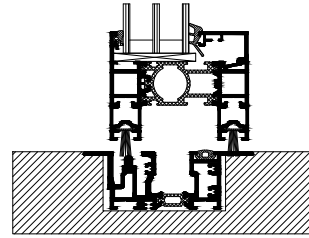

TYPE 02

- Flush floor track
- Accessible without rebate

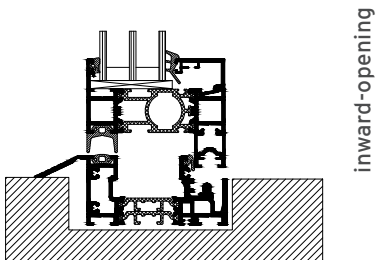

TYPE 03

- Floor track suitable for living spaces
- Accessible with 14 mm rebate

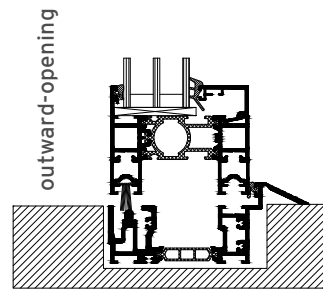

TYPE 04

- Floor track suitable for living spaces
- Accessible with 14 mm rebate

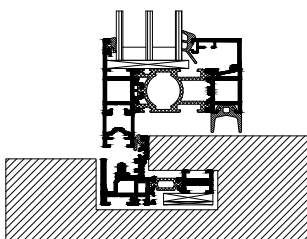

TYPE 05

- Minimalist floor track (29 mm)
- Accessible with 14 mm rebate

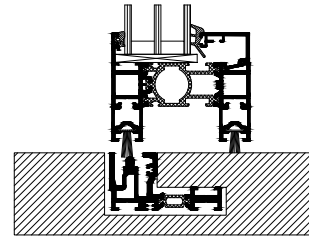

TYPE 06

- Minimalist floor track (29 mm)
- Accessible with 0 mm height offset

MEGALINE BI-FOLDING DOOR

System features

PROFILE SYSTEM

- Modular highly heat-insulated aluminium profile system with building depth of 84 mm
- Bottom-running; minimal load support required in case of falls
- Edged profiling
- Sight line of 132.5 mm in the panel butt joint, depending on structural requirements such as e.g. extreme wind loads it is possible to add structural profiles in the panel area.
- This results in a sight line of 129 mm in the panel butt joint
- Single-piece, multi-functional insulating bar "bionicTURTLE®" made of fibreglass-reinforced polyamide
- Loose shear bond built into thermal break to compensate for thermal loads
- Mitred panels connected by corner connections that are glued and pressed together on the inside to create a sturdy joint
- Controlled drainage
- Built-in running tracks and guide rails
- Separate levels for runners and locking
- Floor track (accessible and suitable for living spaces) available
- Built-in, concealed cable routing

SEALING SYSTEM

- The seal encompasses two all-round sealing levels with constant crack dimensions and even seal pressure between the panels
- Sealing levels are not interrupted by fittings
- Sheathed foam seals with optimum sliding properties
- With optional convection chamber interruption seals for improved thermal transmittance
- Up to three sealing levels available

DESIGN VARIANTS

- Panels fold either inwards or outwards, to either left or right
- Floor track designs without rebates in compliance with German standard DIN 18040 on "Accessible construction"
- Floor tracks available as minimal floor tracks without height offset

FITTINGS

- No upstream running tracks or guide rails
- Fittings for one-hand operation in profiles
- With optional built-in TwinX concealed panel centring mechanism for high wind loads
- System hinges also suitable for heavy panel weights
- System adjustment mechanism built into sub-frame rebate, outside the sealing level
- The specially shaped stainless steel running track with tapered track roller allows the use of unguided carriages
- Stainless steel ball bearing runner mechanism: low-noise, extremely durable stainless steel track roller and bearing surface
- Easy-running, low-wear carriage fitted with double-row deep-groove ball bearings and built-in anti-prying guard
- Sliding lock or optional lockable panels for controlled ventilation
- High-quality, stainless steel Solarlux designer handles
- Lockable one-hand operation thanks to special gears with 24 mm latch bolt
- Passdoor available with latch-key-activated, multi-point lock and profile cylinder
- Secured hinge pins
- Closing monitor with reed contacts and concealed cable routing
- Optional load-transferring installation plates with centring grooves and sealing cushions for attachment of the sub-frame profiles and floor track
- Additional attachment screw covers in frame rebate





ENVIRONMENT

- Sustainable manufacturing
- Certified disposal in accordance with DIN EN ISO 14001: 2009

COMPANY

- In-house production control
- Tested in accordance with DIN EN 1090, design class EXEC1 & EXEC2
- Certified in accordance with DIN ISO 9001

Features

	Resistance to wind load in accordance with DIN EN 12210	B4
	Impermeability to driving rain in accordance with DIN EN 12208	7A
	Air permeability in accordance with DIN EN 12207	3
	Resistance to repeated opening and closing in accordance with DIN EN 12400	2
	Thermal transmittance in accordance with DIN EN ISO 10077-1	$U_w \geq 0.9$ W/m²K

Note: Specifications vary depending on version and glass

Panel sizes

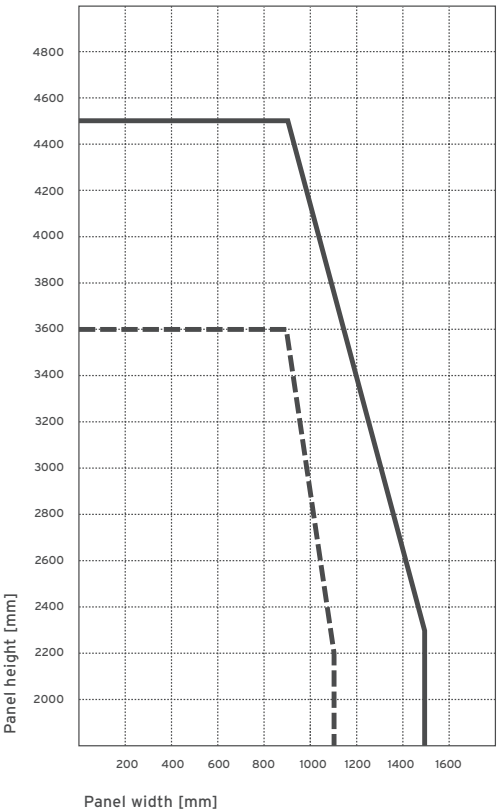

— — — — —
Applies to fill-ins/glazing
max. 20 kg/m² / double glazing

- - - - -
Applies to fill-ins/glazing
max. 35 kg/m² / triple glazing

SIGHT LINES

- | | |
|------------------------|-----------|
| • Frame | 0 - 99 mm |
| • Panel | 66 mm |
| • Panel butt joint | 132.5 mm |
| • Frame building depth | 84 mm |
| • Panel building depth | 84 mm |
| • Minimal floor track | 29 mm |

GLAZING

- Suitable for use with glass thicknesses of 22 - 60 mm
- Dry glazing

NOTES

- Dimensions include frame
- Horizontal rails may be necessary for structural reasons for construction heights over 2,550 mm
- Panel weight max. 150 kg
- min. panel width 800 mm for paired configuration
- Not taking wind and impact loads into consideration
- Special sizes available on demand
- If a swing panel is required, this must be attached by hinges to the frame, the panel width is reduced. Max. height of swing panel 3.000 mm

